

INSTRUCTION SHEET

Direct/ Indirect

Front View

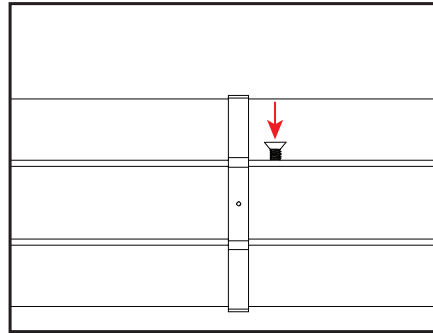
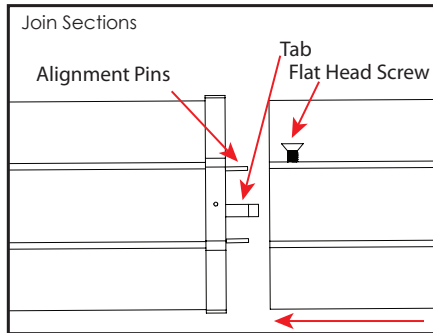

Top View

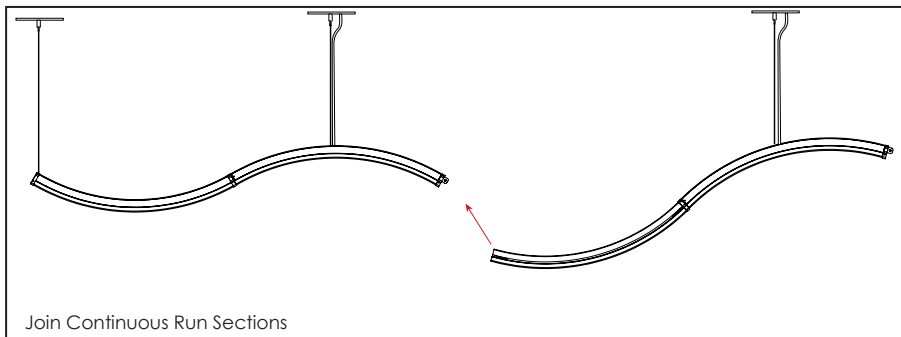
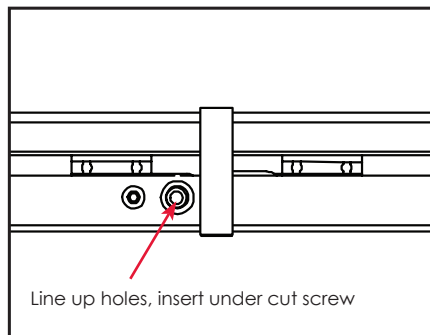
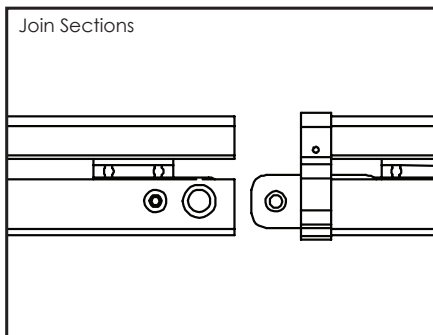

Install Covers

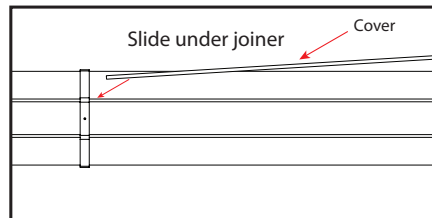
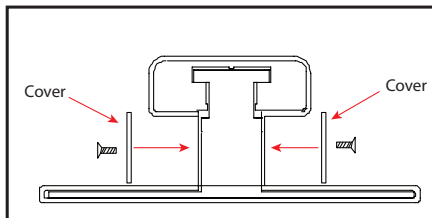

1. See appropriate Stand Alone J-Box mounting (Jbox by others) or provided shop drawings for J-Box spacing for continuous run and special configurations. Assure that all J-Boxes are properly grounded.
2. Secure bracket bar to mud ring or in the case of "NC" option mount 1/4-20 stud to structure and install cable gripper.
3. For fixtures 8' or less, place fixture on a suitable work table. Connect the quick connect on the end of the fixture. To join sections, slide each fixture together and insert the tab and pins to joiner. Check the screw hole to assure all screw holes line up. Insert provided flat head screw and fasten tightly.
4. Repeat instruction #3 for each section there after.
5. Lift fixture in place and feed cables through canopy into cable grippers.
6. Run powercord through canopy into J-box and make up wire connections.
7. Adjust cable to desired length and cut excess, be careful not to fray ends.
8. Install canopy with canopy mounting coupler.
9. Make sure all sections are securely fastened together before hanging.
10. Install cover plates by sliding one end under joiner. Lift cover plate by bowing slightly and slide other end into joiner. Secure with provided small white head screw.

Continuous Run Info

1. Secure all bracket bars to mud ring or in the case of "NC" option mount 1/4-20 stud to structure and install cable grippers.
2. Starter - Connect all sections between cables for the starter (8' section max). Follow #3 instruction above to assemble sections.
3. Middle - This assembled section will only have a cable on one end. Feed the cable into cable gripper in appropriate J-box and raise middle section to connect with starter.
4. To lock together, align fixtures and connect with provided flat head screw.
5. Repeat process for rest of the fixtures in the run.
6. Adjust cable to desired length and cut excess, be careful not to fray ends.
7. Install canopy with canopy mounting coupler.
8. Install covers on both sides of the sections by getting one end under joiner and then slide over and get other end under joiner. Secure with provided white head small flat head screw

Note: To be installed by a qualified electrician per N.E.C. and all local codes.

820-00147

V-1119