

# Installation Instructions

JAKE PER - PERIMETER FLUSH - Trimless Mud Flange - Side Blocking Install

820-00135 (V-0822)  
1 of 1

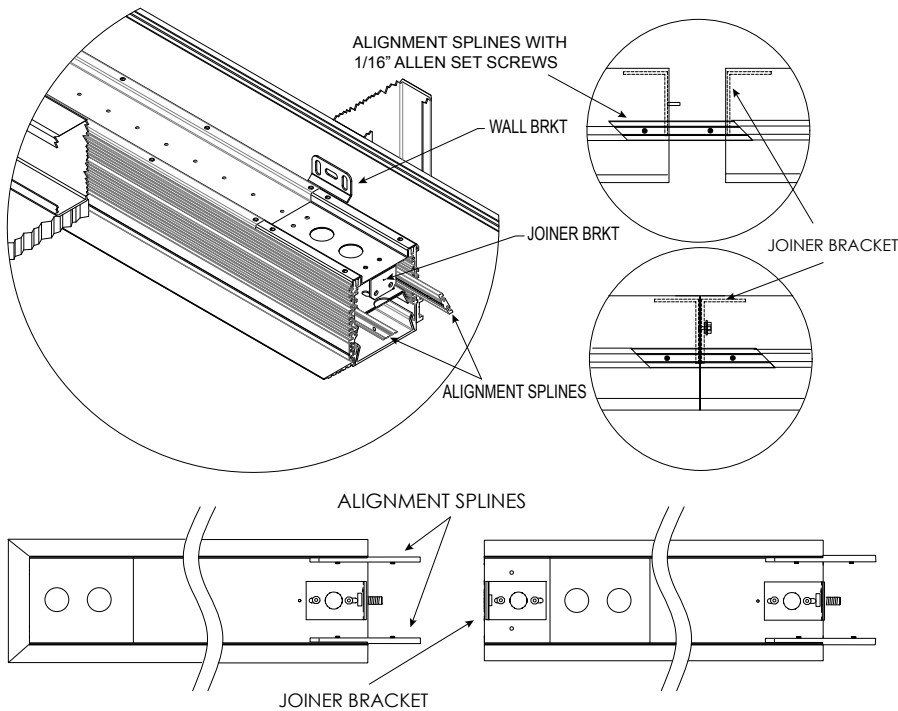

ROUGH-IN WIDTH	
PERIMETER FLUSH FIXTURES	
	TR/TL
165	2.563"
225	3.000"
325	4.000"
500	5.750"

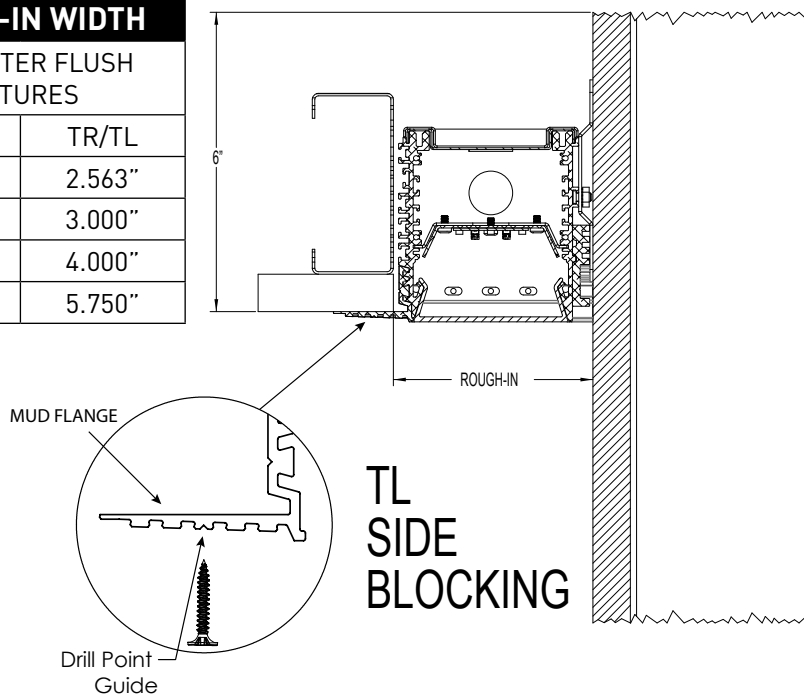

1. See continuous run matrix for rough-in opening length.
2. Ensure wall is extended 6" above ceiling.
3. Adjust wall brackets to align with wall studs or blocking support.
4. For continuous runs, remove lens and reflector/liner.
5. Install fixture(s) into roughed-in opening and install screws thru wall brackets and mud flange. For continuous runs, do not completely tighten screws until alignment splines are positioned between sections and tightened, and joiner brackets are tightened. Note: ensure fixture does not warp when tightening screws. Check by making sure lens fits properly.
6. Bring conduit to fixture thru access panel or end cap and make wire connections inside fixture. Access panel can be temporarily removed to simplify wiring.
7. Install lens prior to finishing to ensure proper fit.
8. Remove lens to finish mud and painting.
9. Reinstall reflector/liner and lens.

**Note:** To be installed by qualified electrician per N.E.C and all local Codes.

INSTALLATION SHEET L/M-08022022 P-1

**BIRCHWOOD LIGHTING** | 3340 E La Palma Ave, Anaheim, CA 92806 | tel 714 550-7118 | fax 714 550-7151 | [www.birchwoodlighting.com](http://www.birchwoodlighting.com)  
For Birchwood Lighting's limited product warranty, go to [www.birchwoodlighting.com](http://www.birchwoodlighting.com). For a printed copy of the warranty, you may call 800 961-5321.  
© 2022 Birchwood Lighting, Inc. All rights reserved. **Note:** This document is subject to change without notice.

**BIRCHWOOD** | a **LEVITON**  
lighting company