

WP SYSTEM

WP-T8-1ST

I-LAMP STAGGER

I-T8 LINEAR LAMP

- 20 gauge steel construction, also available in aluminum, add "AL" in "Options" space
- uses standard T8 fluorescent lamps, other lamp types available
- one-lamp cross section with a standard lamp stagger of 3", 4 1/2" or 6", two-lamp cross section and other stagger amounts available
- standard ballasts are integral electronic, consult factory for available types of dimming and emergency ballasts
- fixtures are available in nominal lengths of 2, 3, and 4 feet, see part numbers to the right for actual fixture lengths
- standard finish is High Reflectivity White powder coat done post production, decorative Large Pattern Galvanize and other custom colors and finishes are also available
all WP System fixtures are treated with a multi-stage phosphate process which ensures proper finish bonding and inhibits rust
- optional standard and custom shape solid, slotted or perforated reflectors available
- UL and C-UL Listed for Dry and Damp Locations

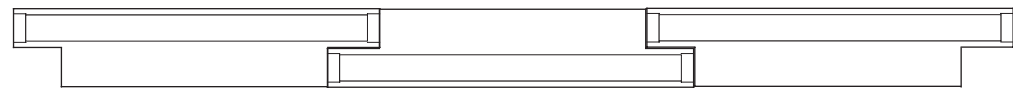
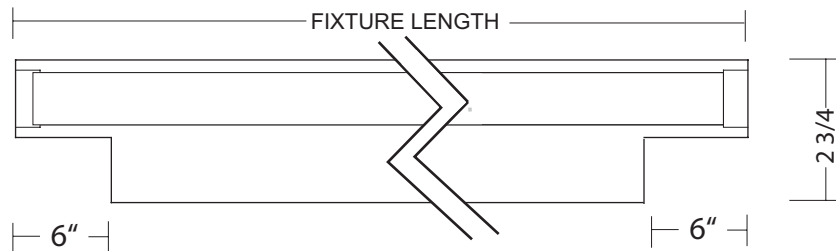
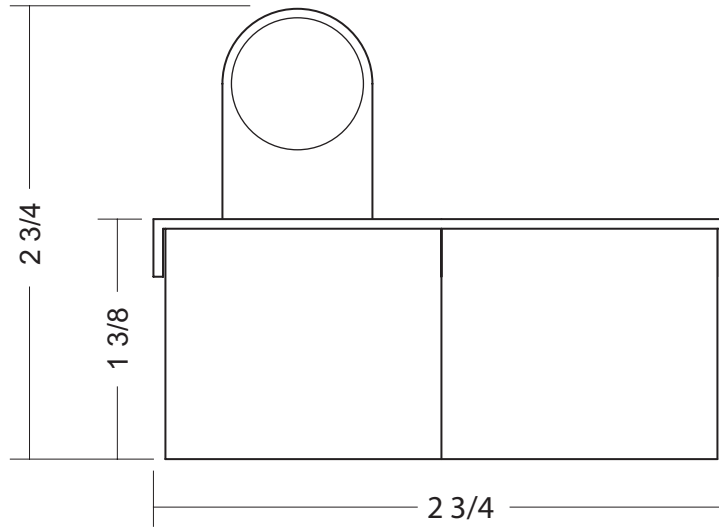

Overlap variable in the field to 3", 4 1/2", or 6"

Job Information

Type _____

Job Name _____

Location _____

WP	1ST	Voltage	Run or Single Fixture Length	Options
Family WP	Lamp Type T8 - Standard T8	120 277 347	RUN-(run length) or T8 117 - 24" 121 - 36" 132 - 48"	
	Model 1ST - one-lamp cross-section stagger	Stagger 3" 4 1/2" 6"		Finish HRW - High Reflectivity White LPG - Large Pattern Galvanize CU - Custom (please specify)
		Ballast EB - electronic DIM__ - dimming* EM__ - emergency* *refer to Options p5 for DIM__ and EM__ options code		

BIRCHWOOD LIGHTING

714.550.7118 • fax 714.550.7151 • www.BirchwoodLighting.com

NOTE: Specifications and dimensions are subject to change without notice.



WP-T8 - p13