

WP SYSTEM

WP-T5-2ST-SAS
WP-T5HO-2ST-SAS

2-LAMP SLIDING
ADJUSTABLE STAGGER

T5 or T5HO LINEAR LAMPS

- 20 gauge steel construction, also available in aluminum, add "AL" in "Options" space
- uses standard or high output T5 fluorescent lamps, other lamp types available
- two-lamp cross section with an adjustable stagger, sliding section locks in place
- standard ballasts are integral electronic, consult factory for available types of dimming and emergency ballasts
- fixtures are available in nominal lengths of 2, 3, 4, 5 and 8 feet, see part numbers to the right for actual fixture lengths
- standard finish is High Reflectivity White powder coat done post production, decorative Large Pattern Galvanize and other custom colors and finishes are also available
all WP System fixtures are treated with a multi-stage phosphate process which ensures proper finish bonding and inhibits rust
- optional standard and custom shape solid, slotted or perforated reflectors available
- UL and C-UL Listed for Dry and Damp Locations

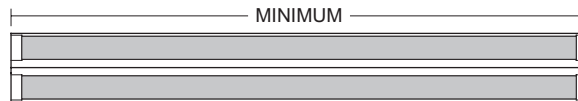
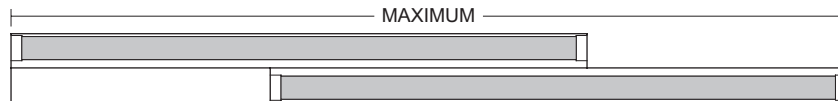
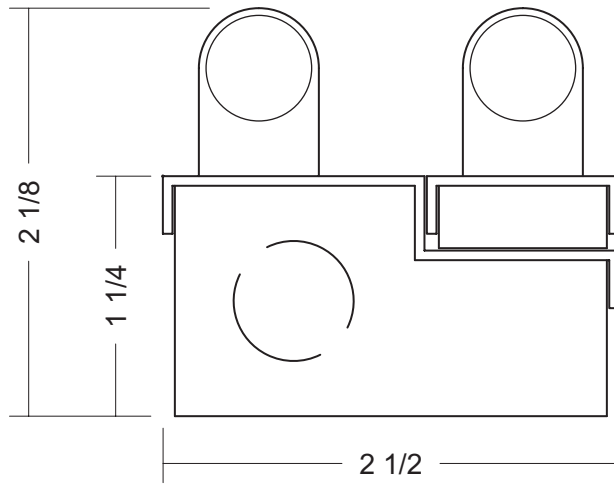

T5 or T5HO	LENGTHS	
	MIN	MAX
114 or 124	22 7/16"	32 1/8"
121 or 139	34 1/4"	49 7/8"
128 or 154	46 1/16"	67 9/16"
135 or 180	57 7/8"	85 5/16"

Job Information
Type _____
Job Name _____
Location _____

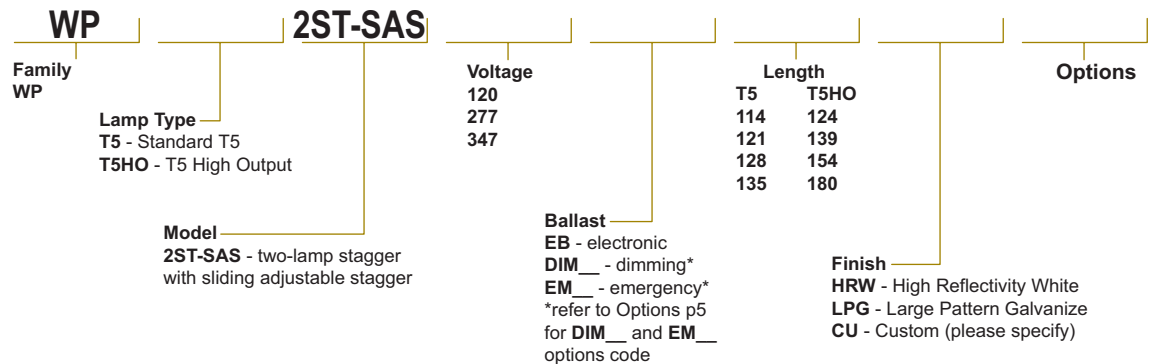

BIRCHWOOD LIGHTING

714.550.7118 • fax 714.550.7151 • www.BirchwoodLighting.com

NOTE: Specifications and dimensions are subject to change without notice.



WP-T5 - p15