

WP SYSTEM

WP-MB-S

STANDARD

MEDIUM BASE INCANDESCENT LAMP

- .050 aluminum construction, also available in steel, add "ST" in "Options" space
- built to accommodate medium base incandescent lamps, such as "A" or "PAR" types, other lamp types available
- one, two, four and six lamp units are standard, custom lengths also available
see part numbers to the right for actual fixture lengths
- standard finish is High Reflectivity White, Satin Anodized, decorative Large Pattern Galvanize and other custom colors and finishes are also available
all WP System fixtures are treated with a multi-stage phosphate process which ensures proper finish bonding and inhibits rust
- optional standard (shown) and custom shape solid, slotted or perforated reflectors available
- UL and C-UL Listed for Dry and Damp Locations

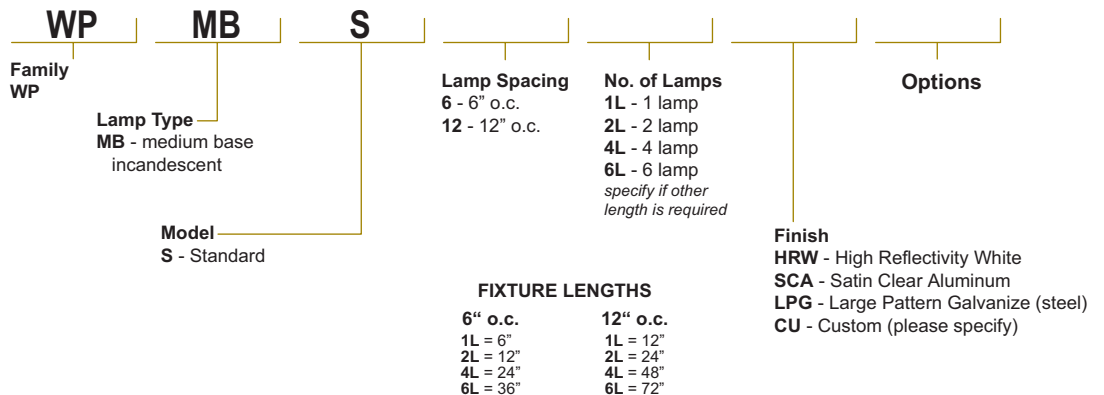
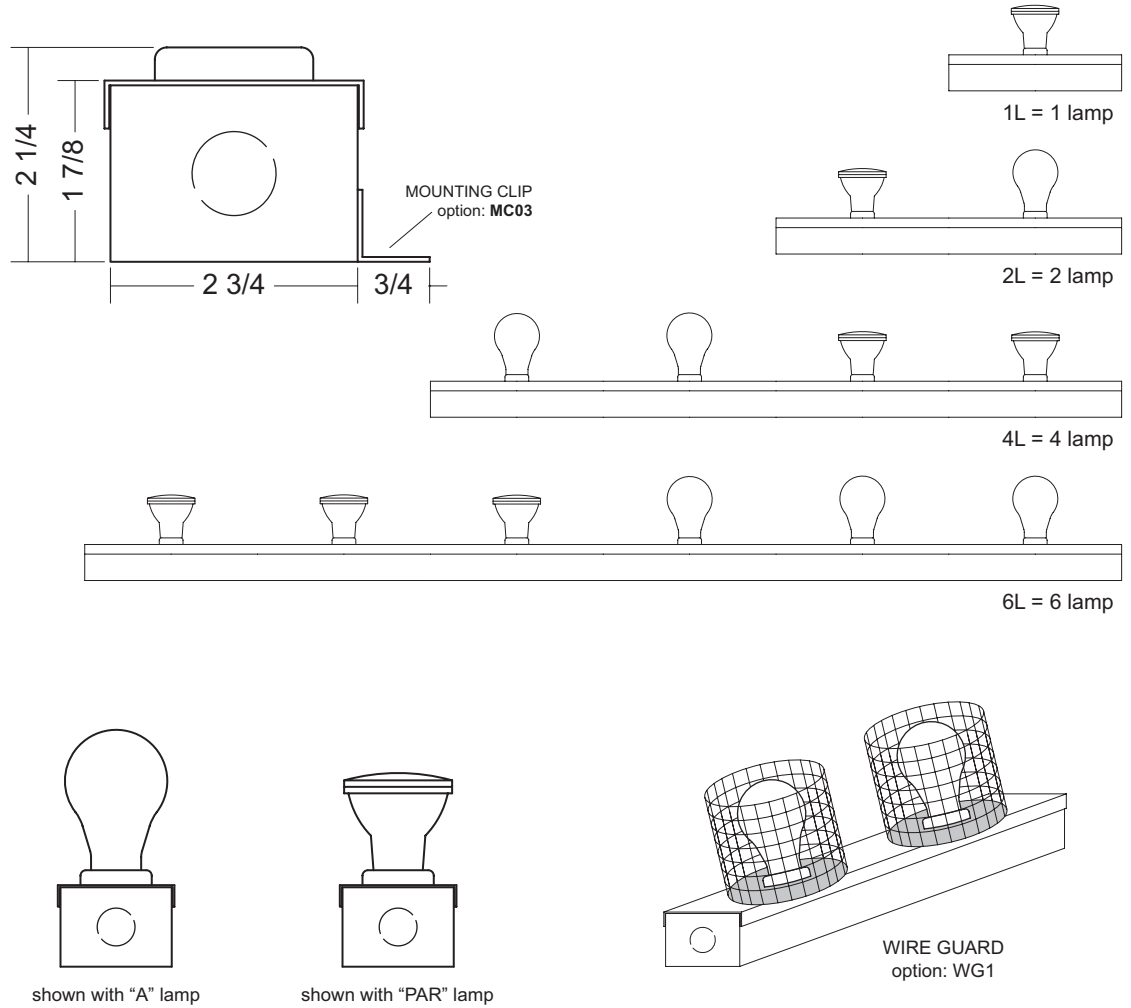

Job Information	
Type	_____
Job Name	_____
Location	_____

BIRCHWOOD LIGHTING

714.550.7118 • fax 714.550.7151 • www.BirchwoodLighting.com

NOTE: Specifications and dimensions are subject to change without notice.



WP SYSTEM

WP-T6¹/₂-S

STANDARD

T6¹/₂ INCANDESCENT LAMP

- .050 aluminum construction, also available in steel, add "ST" in "Options" space
- intermediate base T6¹/₂ incandescent lamps up to 40 watts each, other lamp types available
- one, three and six lamp units are standard, custom lengths also available see part numbers to the right for actual fixture lengths
- standard finish is High Reflectivity White, Satin Anodized, decorative Large Pattern Galvanize and other custom colors and finishes are also available
all WP System fixtures are treated with a multi-stage phosphate process which ensures proper finish bonding and inhibits rust
- optional standard (shown) and custom shape solid, slotted or perforated reflectors available
- UL and C-UL Listed for Dry and Damp Locations

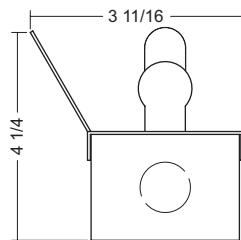
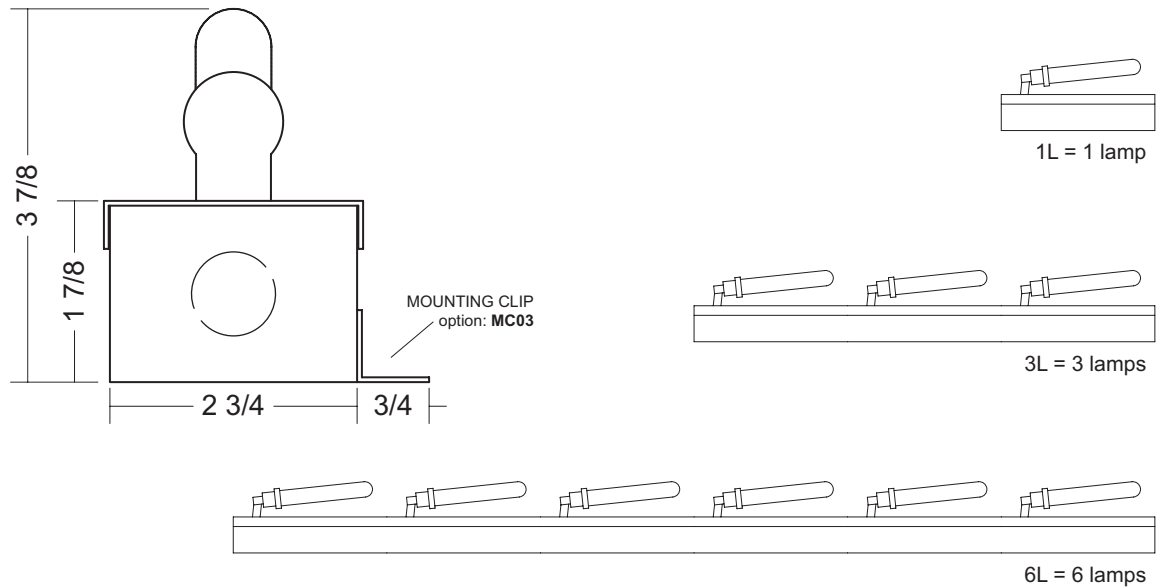

ASYMETRIC REFLECTOR
TYPE 1
option: AR1

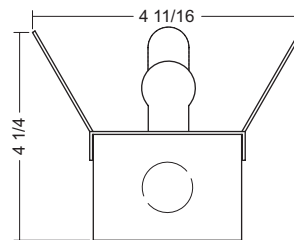

SYMETRIC REFLECTOR
TYPE 1
option: SR1

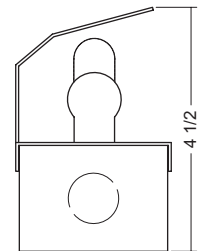

ASYMETRIC REFLECTOR
TYPE 2
option: AR2

Job Information	
Type	_____
Job Name	_____
Location	_____

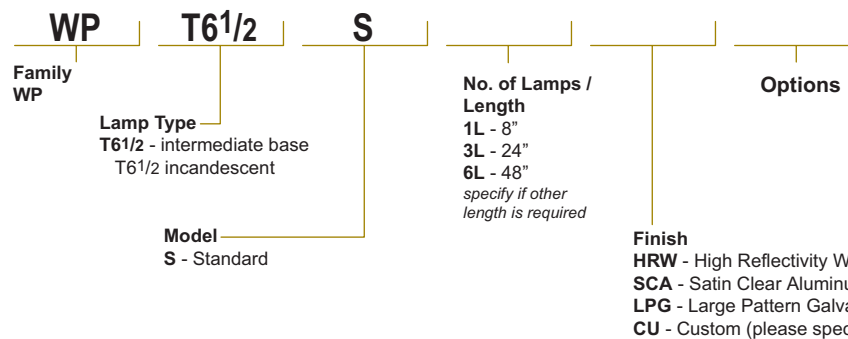

BIRCHWOOD LIGHTING

714.550.7118 • fax 714.550.7151 • www.BirchwoodLighting.com

NOTE: Specifications and dimensions are subject to change without notice.



WP SYSTEM

WP-T6¹/₂-LP

LOW-PROFILE

T6¹/₂ INCANDESCENT LAMP

- 20 gauge steel construction, also available in aluminum, add "AL" in "Options" space
- intermediate base T6¹/₂ incandescent lamps up to 40 watts each, other lamp types available
- one, three and six lamp units are standard, custom lengths also available see part numbers to the right for actual fixture lengths
- fixtures come standard with 9'-0" wire leads and special 3/8" flex connector
- standard finish is High Reflectivity White powder coat done post production, decorative Large Pattern Galvanize and other custom colors and finishes are also available all WP System fixtures are treated with a multi-stage phosphate process which ensures proper finish bonding and inhibits rust
- optional standard and custom shape solid, slotted or perforated reflectors available
- UL and C-UL Listed for Dry and Damp Locations

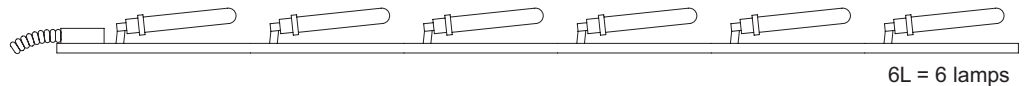
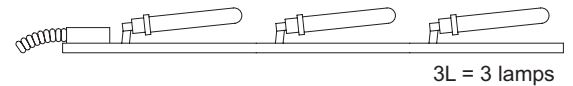
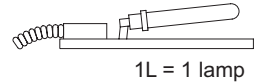
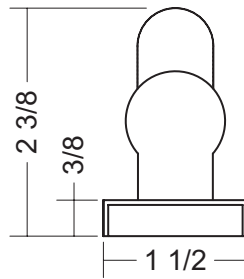

Job Information

Type _____

Job Name _____

Location _____

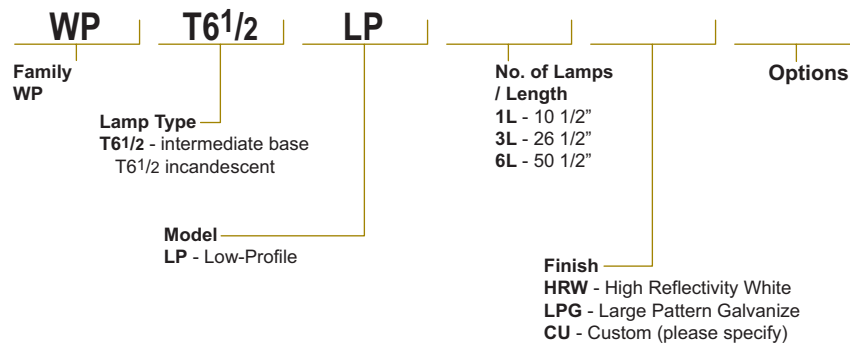

BIRCHWOOD LIGHTING

714.550.7118 • fax 714.550.7151 • www.BirchwoodLighting.com

NOTE: Specifications and dimensions are subject to change without notice.



WP SYSTEM

WP-T10-S

STANDARD

T10 INCANDESCENT LAMP

- .050 aluminum construction, also available in steel, add "ST" in "Options" space
- medium base T10 incandescent lamps up to 60 watts each, other lamp types available
- one, three and six lamp units are standard, custom lengths also available see part numbers to the right for actual fixture lengths
- standard finish is High Reflectivity White, Satin Anodized, decorative Large Pattern Galvanize and other custom colors and finishes are also available all WP System fixtures are treated with a multi-stage phosphate process which ensures proper finish bonding and inhibits rust
- optional standard (shown) and custom shape solid, slotted or perforated reflectors available
- UL and C-UL Listed for Dry and Damp Locations

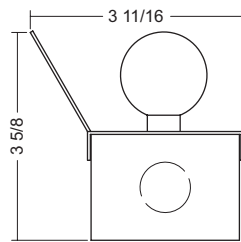
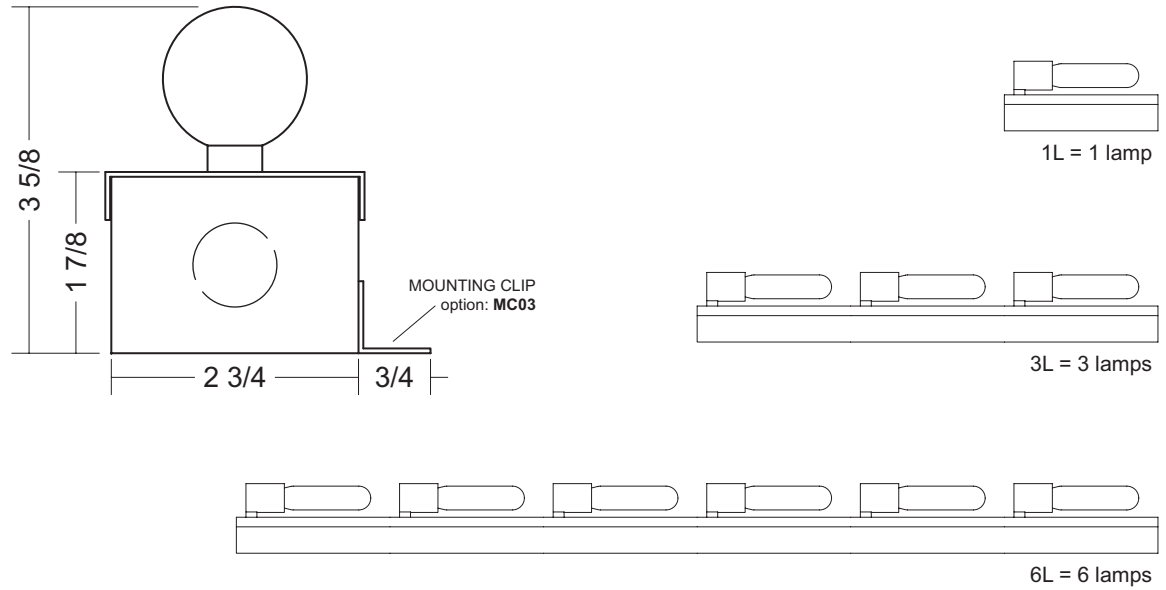

ASYMETRIC REFLECTOR
TYPE 1
option: AR1

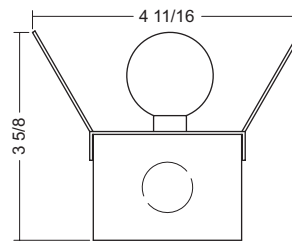

SYMETRIC REFLECTOR
TYPE 1
option: SR1

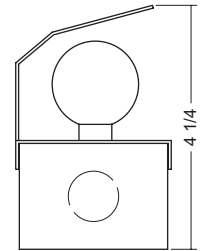

ASYMETRIC REFLECTOR
TYPE 2
option: AR2

Job Information	
Type	_____
Job Name	_____
Location	_____

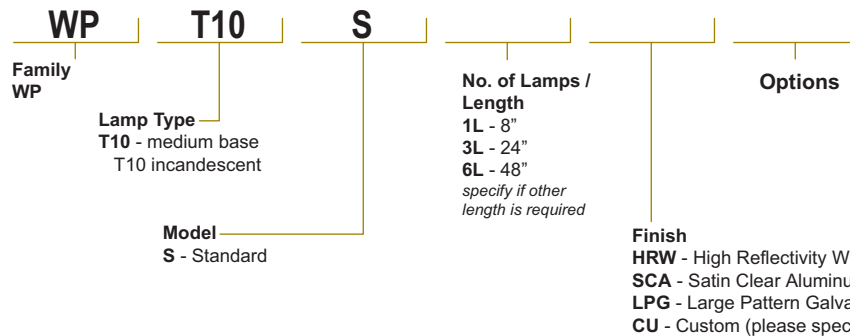

BIRCHWOOD LIGHTING

714.550.7118 • fax 714.550.7151 • www.BirchwoodLighting.com

NOTE: Specifications and dimensions are subject to change without notice.



WP SYSTEM

WP-T10-LP

LOW-PROFILE

T10 INCANDESCENT LAMP

- 20 gauge steel construction, also available in aluminum, add "AL" in "Options" space
- medium base T10 incandescent lamps up to 60 watts each, other lamp types available
- one, three and six lamp units are standard, custom lengths also available see part numbers to the right for actual fixture lengths
- fixtures come standard with 9'-0" wire leads and special 3/8" flex connector
- standard finish is High Reflectivity White powder coat done post production, decorative Large Pattern Galvanize and other custom colors and finishes are also available all WP System fixtures are treated with a multi-stage phosphate process which ensures proper finish bonding and inhibits rust
- optional standard and custom shape solid, slotted or perforated reflectors available
- UL and C-UL Listed for Dry and Damp Locations

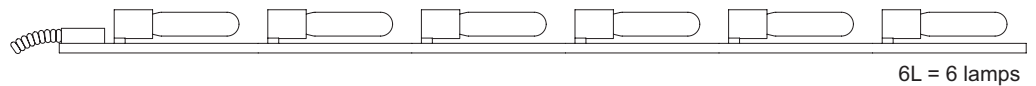
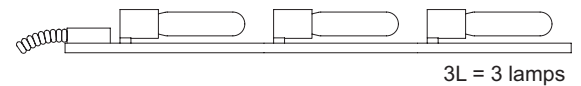
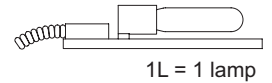
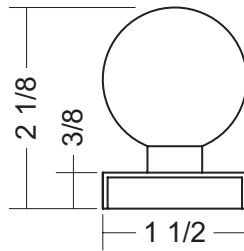

Job Information
Type _____
Job Name _____
Location _____

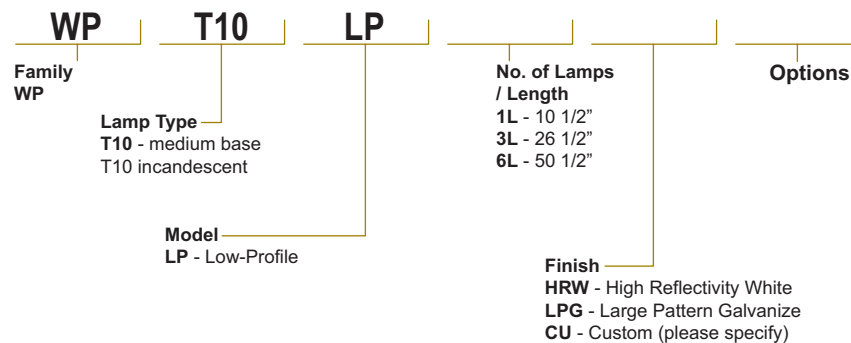

BIRCHWOOD LIGHTING

714.550.7118 • fax 714.550.7151 • www.BirchwoodLighting.com

NOTE: Specifications and dimensions are subject to change without notice.

