

NEYSYDNEYSYD



BIRCHWOOD LIGHTING

SYDNEY - Field Curvable Lighting System

Imagine the possibilities with unlimited curvability. Sydney is so flexible that it can be curved during installation in any direction: vertical, horizontal or any compound angle in between. Sydney's curve and length is variable so there is no need for precise measurements when ordering.

Not only is Sydney versatile, it also packs a punch. The light source comes from multiple high lumen twin, quad and hex tube compact fluorescent lamps. These high performance lamps feature high efficacy, excellent color rendering and a long life.

Now you have the freedom to easily put lighting into tight curved spaces such as circular coves or dynamically configured soffits. Sydney is easily specified, easily installed and is virtually self conforming to most curved spaces. When standard "rope light" or cold cathode is not enough to do the job, use Sydney to create continuous dramatic or subtle effects.

Patented Connection

Birchwood Lighting's patented Versacurve connector allows for a "telescopic" dynamic between modules. This makes the distance between modules variable in the field, which makes filling a space easy. No longer is there a need for exact field measurements. With its unlimited adjustability, the Versacurve connector also allows Sydney runs to conform to the space without the need to adjust any mechanical connections.

Mounting Clips

Sydney is available with optional pre-installed mounting clips from the factory. These clips allow installation without the need to open each individual module. Sydney runs are shipped in shorter pre-wired, pre-connected lengths, which are easily connected to each other in the field to make longer runs. This saves time and money on installation.

Lamp Types

Sydney is available with several different lamp types. Compact fluorescent lamp types include high lumen twin, quad and hex tube. Incandescent lamp types are medium base, T10, T6 1/2, low-voltage and many others. Utilizing different Kelvin temperature lamps lends Sydney to all kinds of projects, including commercial, health care, educational, office spaces and residential applications.

Finishes

Although Sydney is usually hidden from view, it is available in a variety of standard finishes as well as unlimited custom colors and finishes. The standard finish for Sydney is High Reflectivity White and Satin Clear Anodize is also readily available.

Ballasts

There are several standard and dimming ballast options available with Sydney. Emergency battery packs can be factory installed and wired accordingly. Birchwood Lighting works closely with all of the industry's major names in lamps and ballasts. This keeps us on the cutting edge of technological advancements in our industry.

Three Versions

There are three versions of Sydney. Depending on the location and configuration of the space where Sydney is to be installed, the "OL" Over-Lapping, "EE" End-to-End or "SM" Side-Mount version may be used. Use the "OL" version for tight spaces where socket shadows would be a present. The "EE" version is best used in larger spaces where placement may be away from the wall to eliminate socket shadows. Finally, use the "SM" version is used in low ceiling applications to throw light out into the space.



This product is protected by
U.S. Patent 6,702,453

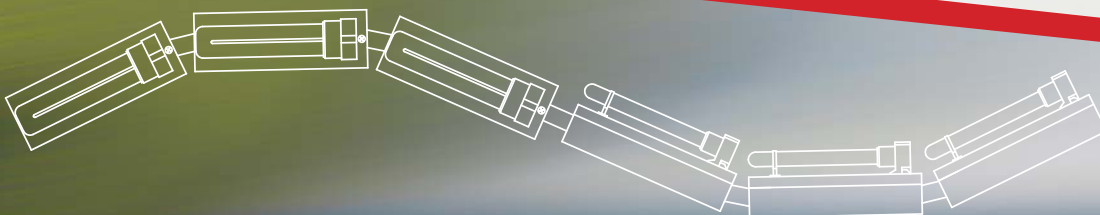

SYDNEY SERIES



SYDNEY SYSTEM

FIELD CURVABLE

- All Sydney fixtures are able to curve in any direction
- Telescoping action makes distance between units adjustable without any tools
- .050 Aluminum construction
- Models using 9 to 80 watt twin-tube, quad-tube and triple-tube fluorescent lamps as well as various incandescent lamp types
- End-to-End, Overlapping and Side Mounted lamp models
- Shipped in short, pre-wired runs from the factory which are easily connected together in the field for longer runs
- Standard finishes are Satin Clear Anodized or High Reflectivity White, custom colors are available
- Some models available with dimming and emergency ballasts
- Optional extended connectors available for longer length adjustment between units
- UL and C-UL Listed for Dry and Damp Locations

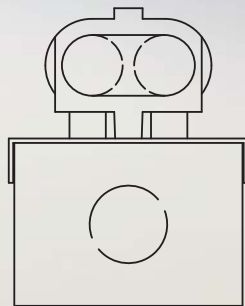

End-to-End

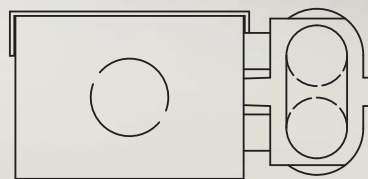

Side Mount

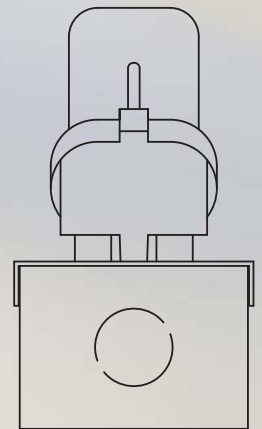

Overlapping

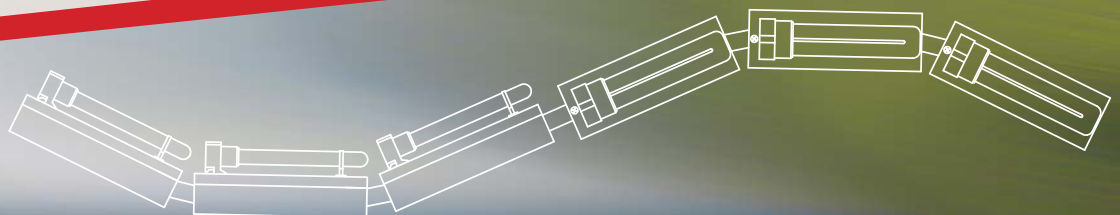

P. 714.550.7118 · F. 714.550.7151

BirchwoodLighting.com

