

# SYDNEY SERIES



## SYDNEY SYSTEM

### FIELD CURVABLE

- All Sydney fixtures are able to curve in any direction
- Telescoping action makes distance between units adjustable without any tools
- .050 Aluminum construction
- Models using 9 to 80 watt twin-tube, quad-tube and triple-tube fluorescent lamps as well as various incandescent lamp types
- End-to-End, Overlapping and Side Mounted lamp models
- Shipped in short, pre-wired runs from the factory which are easily connected together in the field for longer runs
- Standard finishes are Satin Clear Anodized or High Reflectivity White, custom colors are available
- Some models available with dimming and emergency ballasts
- Optional extended connectors available for longer length adjustment between units
- UL and C-UL Listed for Dry and Damp Locations

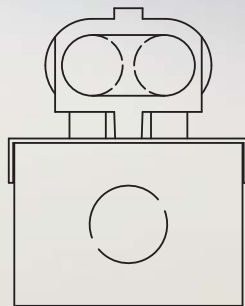

End-to-End

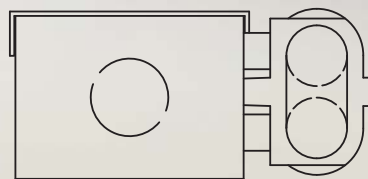

Side Mount

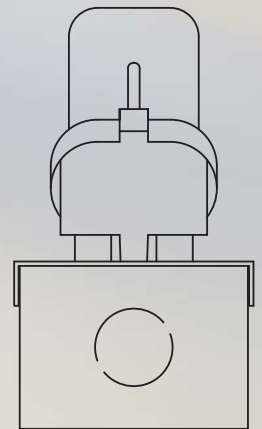

Overlapping

